

Tiger Neo N-type 78HL4-(V) 610-630 Watt MONO-FACIAL MODULE

N-Type

Positive power tolerance of 0~+3%

IEC61215(2016), IEC61730(2016)

ISO9001:2015: Quality Management System

ISO14001:2015: Environment Management System

ISO45001:2018

Occupational health and safety management systems

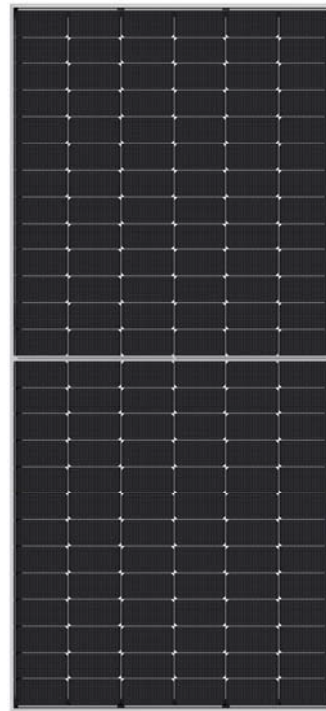

Key Features



SMBB Technology

Better light trapping and current collection to improve module power output and reliability.



PID Resistance

Excellent Anti-PID performance guarantee via optimized mass-production process and materials control.



Durability Against Extreme Environmental Conditions

High salt mist and ammonia resistance.



Hot 2.0 Technology

The N-type module with Hot 2.0 technology has better reliability and lower LID/LETID.



Enhanced Mechanical Load

Certified to withstand: wind load (2400 Pascal) and snow load (5400 Pascal).



LINEAR PERFORMANCE WARRANTY

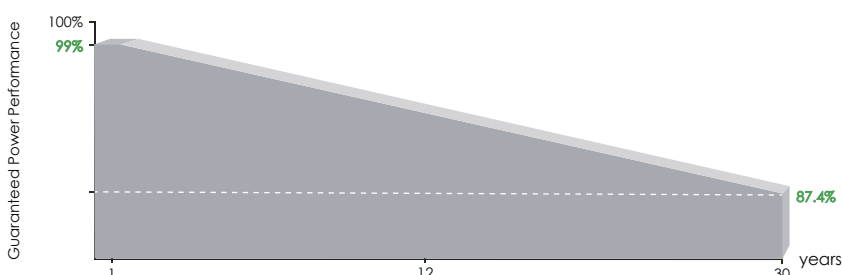

12 Year Product Warranty

30 Year Linear Power Warranty

0.40% Annual Degradation Over 30 years

Engineering Drawings

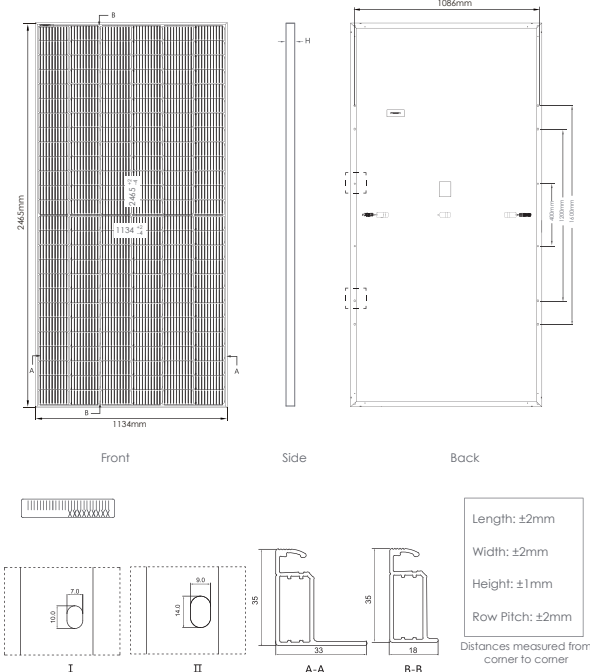

Packaging Configuration

(Two pallets = One stack)

31pcs/pallets, 62pcs/stack, 496pcs/ 40'HQ Container

Electrical Performance & Temperature Dependence

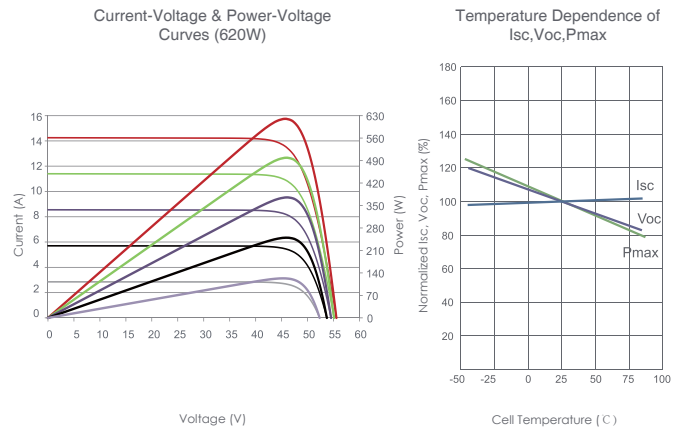

Mechanical Characteristics

Cell Type	N type Mono-crystalline
No. of cells	156 (2×78)
Dimensions	2465×1134×35mm (97.05×44.65×1.38 inch)
Weight	30.6 kg (67.46 lbs)
Front Glass	3.2mm, Anti-Reflection Coating, High Transmission, Low Iron, Tempered Glass
Frame	Anodized Aluminium Alloy
Junction Box	IP68 Rated
Output Cables	TUV 1×4.0mm ² (+): 400mm, (-): 200mm or Customized Length

SPECIFICATIONS

Module Type	JKM610N-78HL4 JKM610N-78HL4-V		JKM615N-78HL4 JKM615N-78HL4-V		JKM620N-78HL4 JKM620N-78HL4-V		JKM625N-78HL4 JKM625N-78HL4-V		JKM630N-78HL4 JKM630N-78HL4-V	
	STC	NOCT	STC	NOCT	STC	NOCT	STC	NOCT	STC	NOCT
Maximum Power (Pmax)	610Wp	459Wp	615Wp	462Wp	620Wp	466Wp	625Wp	470Wp	630Wp	474Wp
Maximum Power Voltage (Vmp)	45.59V	42.28V	45.69V	42.39V	45.79V	42.50V	45.92V	42.61V	46.02V	42.72V
Maximum Power Current (Imp)	13.38A	10.85A	13.46A	10.91A	13.54A	10.97A	13.61A	11.03A	13.69A	11.09A
Open-circuit Voltage (Voc)	55.25V	52.48V	55.40V	52.62V	55.55V	52.77V	55.70V	52.91V	55.85V	53.05V
Short-circuit Current (Isc)	14.11A	11.39A	14.18A	11.45A	14.25A	11.50A	14.32A	11.56A	14.39A	11.62A
Module Efficiency STC (%)	21.82%		22.00%		22.18%		22.36%		22.54%	
Operating Temperature(°C)	-40°C~+85°C									
Maximum system voltage	1000/1500VDC (IEC)									
Maximum series fuse rating	25A									
Power tolerance	0~+3%									
Temperature coefficients of Pmax	-0.29%/°C									
Temperature coefficients of Voc	-0.25%/°C									
Temperature coefficients of Isc	0.045%/°C									
Nominal operating cell temperature (NOCT)	45±2°C									

*STC: Irradiance 1000W/m²

Cell Temperature 25°C

AM=1.5

NOCT: Irradiance 800W/m²

Ambient Temperature 20°C

AM=1.5

Wind Speed 1m/s